

Bona DCS 50



The Bona DCS 50 is a powerful and versatile industrial M class vacuum system developed to handle both very fine and health hazardous dust. It is equipped with a 2-step automatic sensor-controlled filter cleaning system which ensures sustained high levels of suction and efficient dust removal. Large wheels bring good manoeuvrability and its foldable handle makes transport easier. Also, for convenience, all of the pipes and vacuum head are stored on the machine.

The World Health Organisation in Evaluation of carcinogenic risks to humans Vol. 2, 1997, notes: **Wood dust is carcinogenic to humans**. It is very important therefore that floor sanding contractors have an efficient dust control system to protect them and their customers. Bona DCS 50 is ideal for use with timber floor sanding machines but can also be used for other materials. In addition, it can also be quickly converted to use as a wet vacuum.

- Certified filtration efficiency of 99,9% (M class)
- Power outlet with auto-start function
- Integrated storage for accessories
- Wet and dry vacuuming capability
- Drain hose for convenient disposal of liquids



Technical data

Weight:	19 kg
Dimensions:	640 x 370 x 1045 mm
Collection capacity:	Approx. 50 litres
Dust bag:	Fleece filter bag
Motor:	1380 W, 230 V, 50/60 Hz 6 A
Sound pressure level:	dB(A) 69
Filter:	PES
Dust Class:	Class M (EN60 335-2-69)
Hose aperture:	35 mm in diameter
Length of hose:	5 m

For further more detailed technical data please see the machine manual.

Preparation

When using the Bona DCS 50 for the first time, read the machine manual carefully and follow the instructions to set the machine up.

Check that a bag is correctly installed in the collection chamber and that the prefilter is in place. Ensure that the filters are intact and clean.

Connect the vacuum hose to the DCS 50 and the other end to the sanding machine.

Connect the cable to the power socket. For your own safety always use an **earth leakage circuit breaker**.

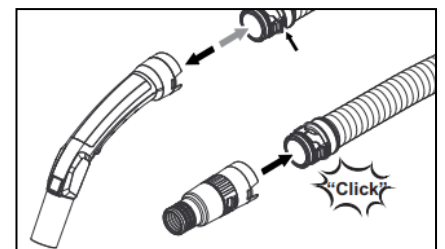

Bona[®]
Phone 1300 882 806

Directions for use

If the sanding machine is connected separately to a wall socket, start the DCS 50 by turning the **On** control switch to position **No.1** before starting to sand.

It is possible to connect a Bona Edger, FlexiSand or similar machine to the DCS50, although a power cable with a European mainland plug is required. This allows the 'Autostart' function to be used. Set the Start switch to position **No.2** Automatic. The DCS 50 is set in standby mode and will start automatically when the sander starts. When the machine is turned off, the DCS 50 will run for approx. 15 seconds to allow the sander to stop completely and to empty the hose.

Do not use a belt sander or similar more powerful machines with the 'Autostart' function; Bona DCS 50 can be used with machines with a power rating of up to 2200W.

N.B. The DCS 50 has a low air flow alarm. It is recommended that the Air Flow Control is opened when using handheld power tools to ensure sufficient air flow is achieved.

Dry Vacuum system operation

It is possible to use the Bona DCS 50 with a plastic dust bag which uses the full volume of the container. This is only suitable for sanding using larger grits and coarse materials. For fine dust, M Class, a fleece filter bag must be used.

To install the fleece filter bag

1. Unlock and remove the top of the machine.
2. Fit the fleece filter bag.
3. Fit and lock the top of the machine.

To change the fleece filter bag

1. Unlock and remove the top of the machine
2. Pull the fleece filter bag on the flange up and out.
3. Seal the fleece filter bag with cap.
4. Dispose of the used fleece filter bag in accordance with local regulations.

When you have finished sanding or the dust bag is full, the bag must be changed. Wood dust, particularly where the timber flooring was previously coated with solvent based products or oils, may spontaneously combust. Do not store the DCS 50, or any sanding machine, with an un-emptied dust bag. All sanding dust removed from the machine should be kept outdoors due to the potential fire hazard.

Wet Vacuum system operation

The fleece filter bag / dust bag must be removed before vacuuming wet substances – see instructions above.

To vacuum wet substances effectively the brushes on the vacuum head must be removed and the squeegee blades installed. The vacuumed liquid comes straight into the container. To drain the liquid waste, use the drain hose at the back of the machine.

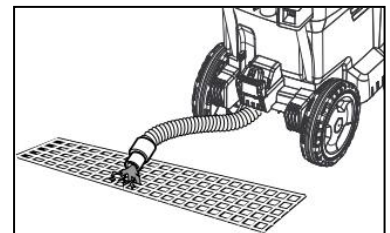

In addition, please note the following points: -

- It is recommended that the "Automatic filter dedusting" function is switched **off** when vacuuming wet dirt with the crevice nozzle or the upholstery nozzle (optional), or when sucking mainly water out of a container.
- The device switches off automatically when the maximum fluid level is reached.
- The DCS 50 does **not** automatically switch off when the container is full when vacuuming non-conductive liquids (e.g. drill emulsion, oils and grease). Monitor the filling level continuously, and empty the container regularly.
- When wet vacuum cleaning has been completed, disconnect the machine. Clean the main filter using the dedusting function. Clean the electrodes with a brush.

Bona[®]

Phone 1300 882 806

Maintenance

Routine maintenance of the DCS 50 requires that it is kept clean and free from dust and other materials. After dry vacuuming the machine should be emptied. Inside and outside should be wiped with a moist soft cloth and / or vacuumed.

After wet vacuuming the machine must be emptied and the container carefully cleaned. This is particularly important if anything other than water-based liquids have been vacuumed. The hose and vacuum head should also be thoroughly cleaned.

The condition of the filter must be monitored and replaced as necessary. In addition, the condition of the hose, and connections, together with the electrical cable should be checked regularly.

Outside of the routine maintenance tasks, major servicing of the DCS 50 should be carried out by a professional machine / electrical workshop.

Bona[®]

Phone 1300 882 806